

**Current Land Use, Facilities and Utilities Map - Village  
Town Plan 2020 - Town of Chester, VT  
Adopted: May 6, 2020**

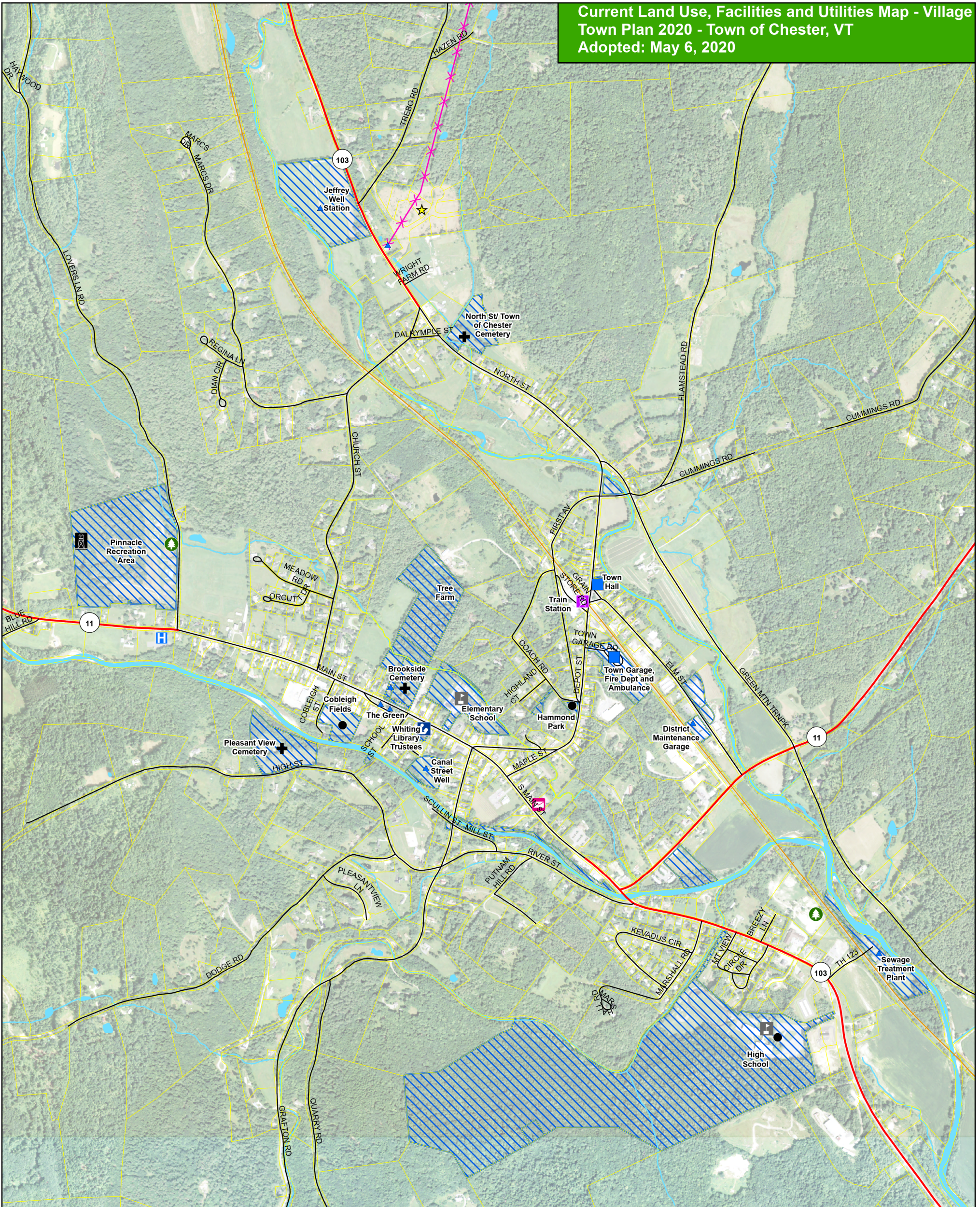

- |                          |                                    |                          |
|--------------------------|------------------------------------|--------------------------|
| Town Services            | Town Park/ Forest/ Recreation Area | Railroad                 |
| Post Office              | Lake or River Access               | Transmission Line        |
| Library                  | Fishing Access                     | Rivers and Streams       |
| Train Station            | Other notable recreation site      | Lakes and Ponds          |
| School                   | Cemetery                           | Public Land              |
| Other Civic/ Public Site | Telecommunications Facility        | Privately conserved land |
| Health Clinic            | State Highway                      | Town Boundary            |
| Large Solar Array        | Town Highway (C1,2,3)              | Parcels                  |
| State Forest             |                                    |                          |

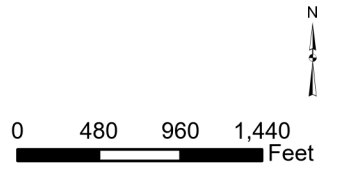

Note: Use of public lands may be restricted.

Data Sources: Telecommunications Tower (Natural Resources Board 2007 and SWCRPC 2013), Electric Transmission Line Corridor (VCGI 2003 and SWCRPC 2015), Public Land and Privately Conserved Land (2010 Town Plan, VLT 2013, UVM 2013, ANR 2012, SWCRPC 2015), Site types (VT E911 July 2015, 2010 Town Plan, SWCRPC 2015), Cemeteries (VTrans 2001, 2010 Town Plan and SWCRPC 2015), Roads (VTrans 2014), Railroad (VTrans 2014), Rivers and waterbodies (VHD 2008), Parcels (CA 2014), Town Boundary (VCGI 2012 and RPC 2014 using Parcels 2014), Aerials (NAIP 2014)

VT State Plane Meters, NAD 83

Map for planning purposes only.  
Not for regulatory interpretation.

Map drawn March 1, 2016

